

### Fume Arm Mounting Flange

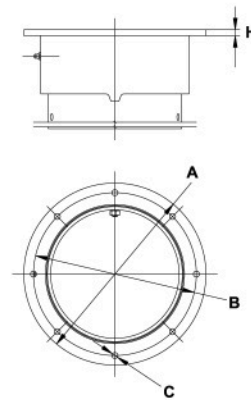

H = 9mm  
 A = Ø275mm  
 B = Ø246mm  
 C = 8 holes Ø9mm

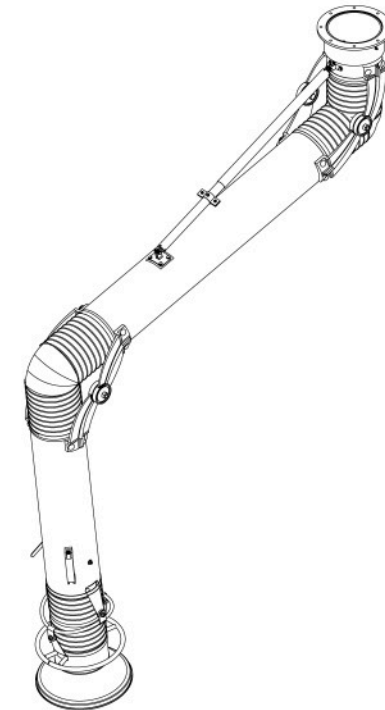

- Accessories and options:**
- P07-01-0005 - Mounting bracket WS-200
  - P02-80-0001 - MOD A light kit & photo sensor
  - P02-80-0002 - MOD L light kit with Switch

- Standard construction:**
- galvanized tubes powder coated color blue RAL5010
  - aluminum hood powder coated yellow RAL1028
  - external aluminum arm joint parts painted black
  - flexible PVC black hose rated (temperature resistance up to 80°C)
  - standard built-in manual damper
  - all external adjustments and supports
  - grab handle all around the hood

